

Jester West Connecting Bath

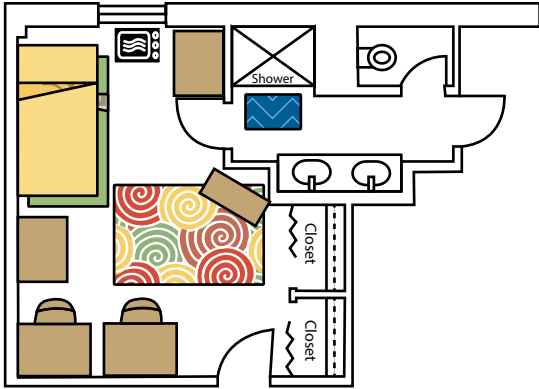

Room Dimensions: 14'-6" x 15'-8"

Window: 68" x 32"

Closet: 72" H x 42" W x 16" D

Microfridge: 44" H x 20" W x 18" D

Bulletin Boards (2): 48" x 48"

Extra Storage: 1 drawer, 1 locked cabinet; 17" x 24" x 30" Under desk
Storage above closet

Adjustable Furniture

Bunkable/Loftable Bed (2)

Twin XL Mattress (80" x 35")

Bed frames: 86" x 39"

Moveable Wooden Desk/Chair (2)

32" x 24" x 30"

Moveable dressers (2)

24" x 30" x 30"

Includes lockable drawer (lock not included)

Can be placed under lofted bed

Bookshelf (1 shared double-sided)

24" x 24" (each side 12" x 12"; 2 shelves)

Note: Student rooms are not carpeted.

4' x 6' or 5' x 8' rugs are recommended.

Jester West Community Bath

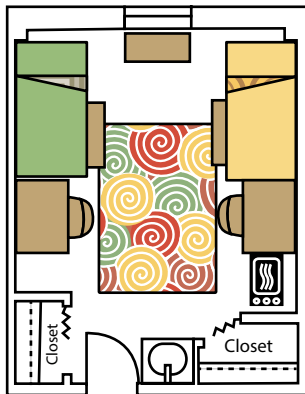

Room Dimensions: 12'-10" x 15'-10"

Window: 68" x 32"

Closet: 72" H x 42" W x 16" D

Microfridge: 44" H x 20" W x 18" D

Bulletin Boards (2): 48" x 48"

Extra Storage: 1 drawer, 1 locked cabinet; 17" x 24" x 30" Under desk
Storage above closet

Standard room layout shown

Actual rooms may vary